

1

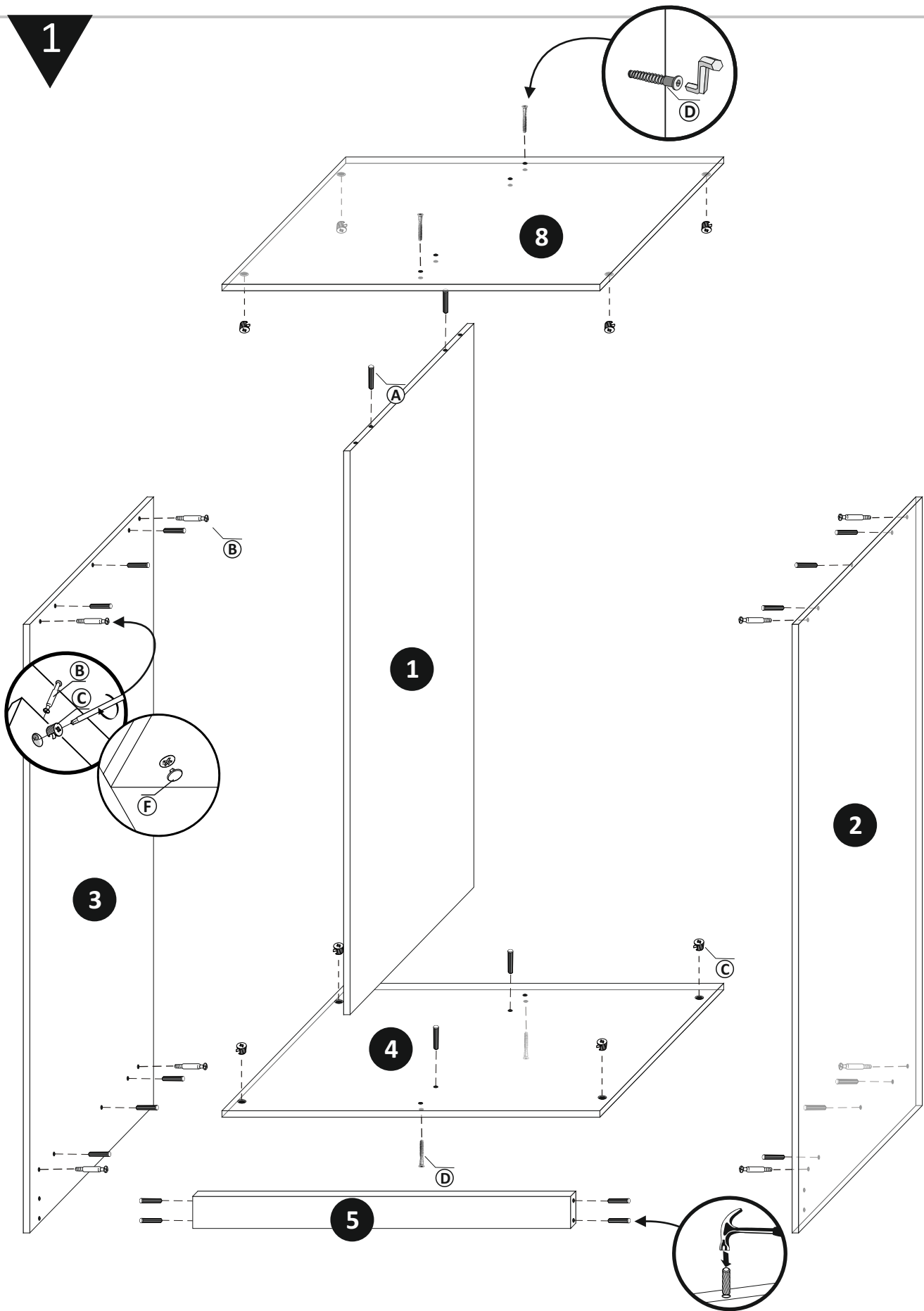

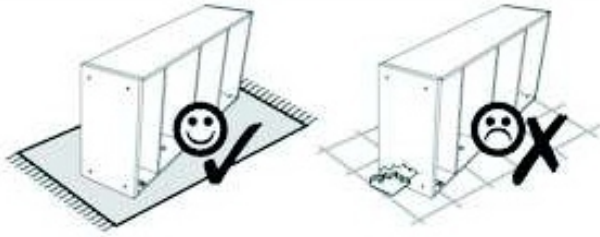

2

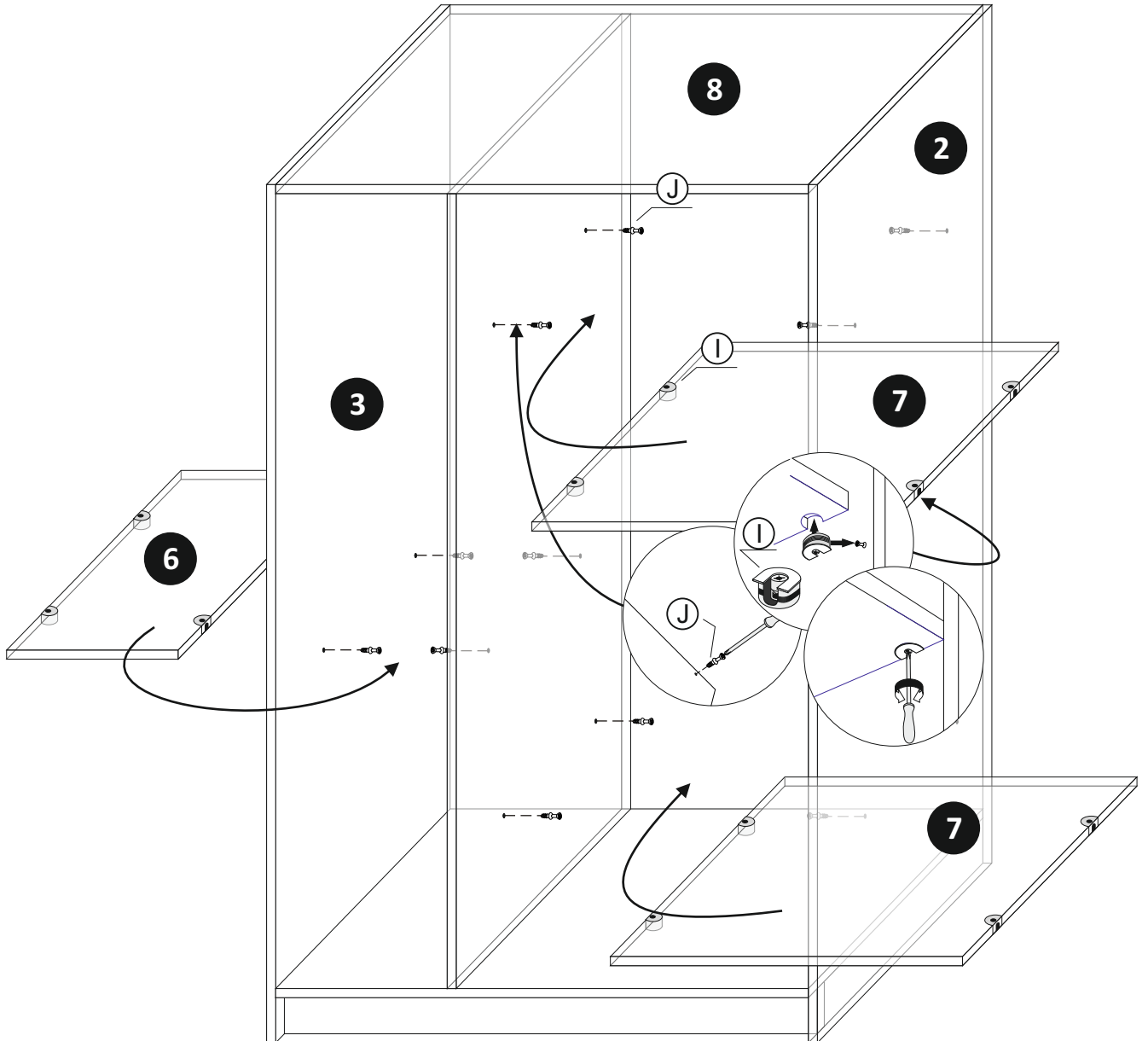

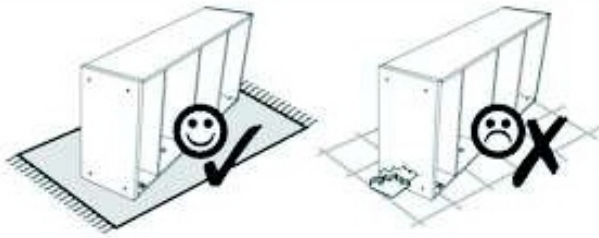

3

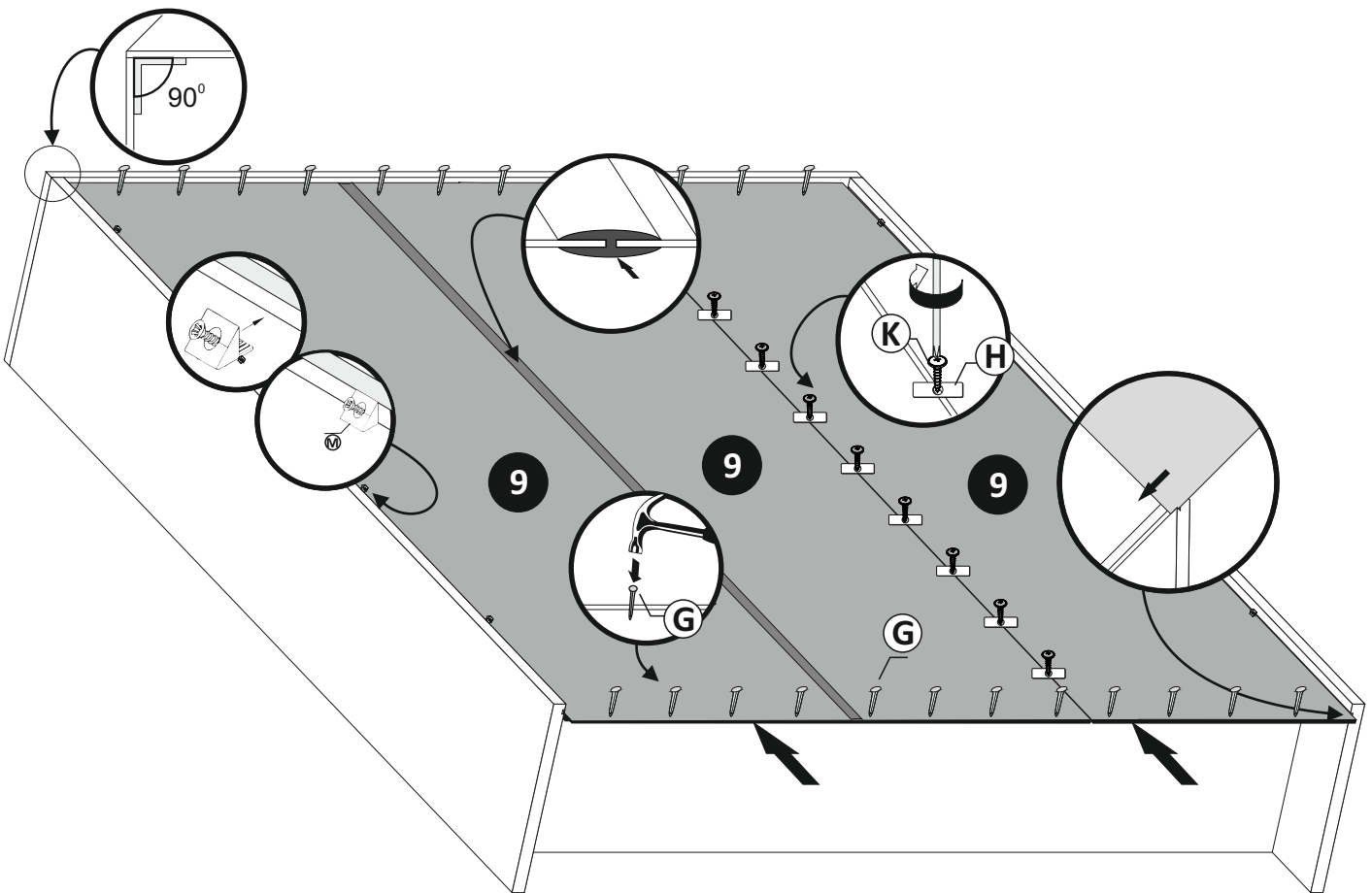

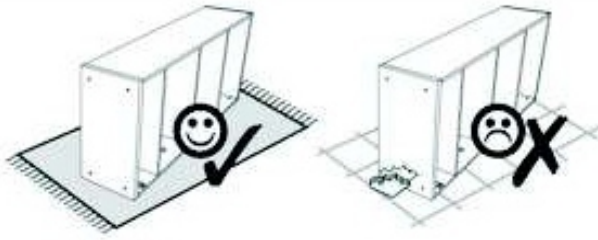

4

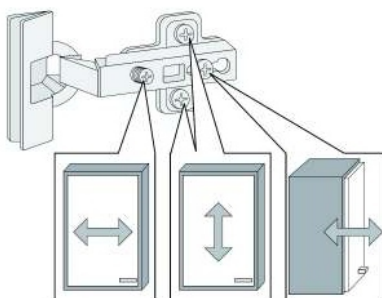
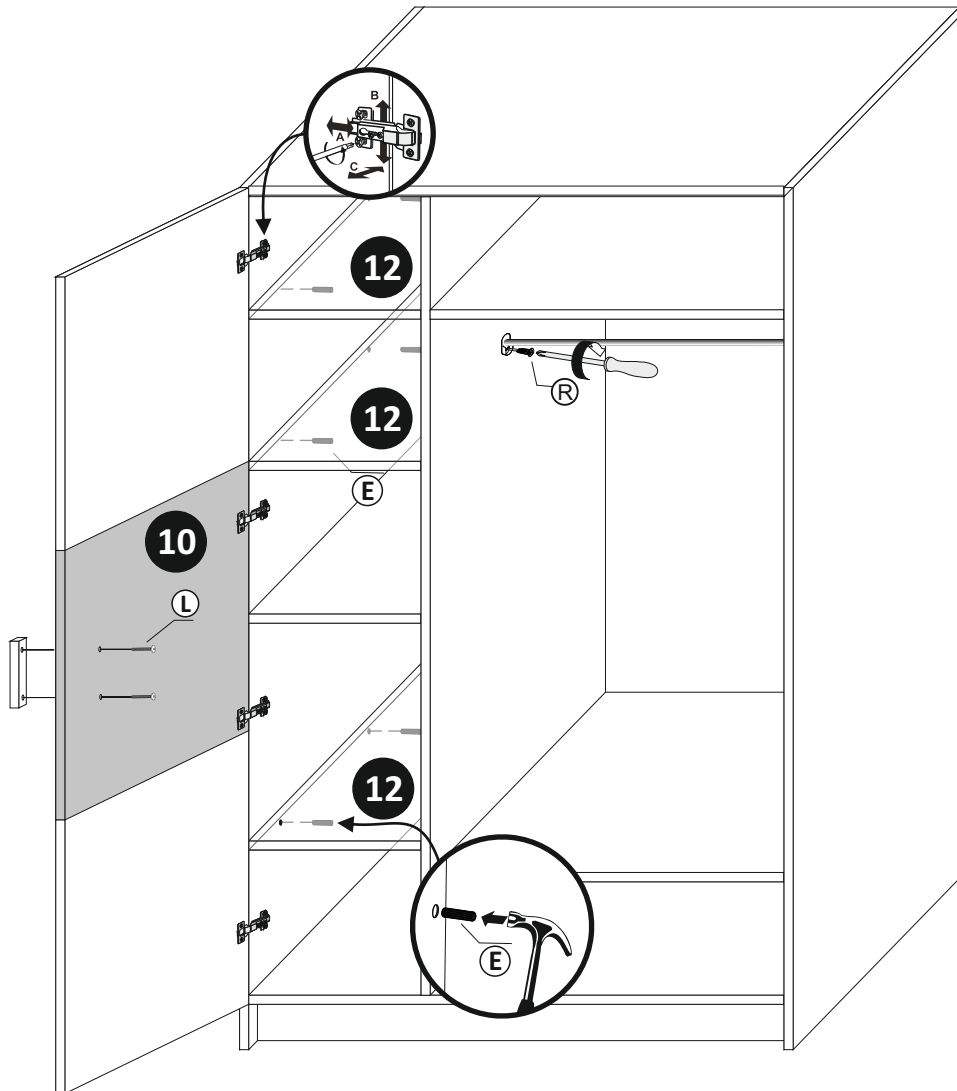

Türen einstellen (Scharniere justieren)
 Adjusting the doors (adjusting the hinges)
Deuren instellen (scharnieren afstellen)
 Nastawić drzwi (wyrównać zawiasy)
Капıларın аярланması (ментешелерın seviye аярı)
 Регулировка дверей (регулировка шарнира)

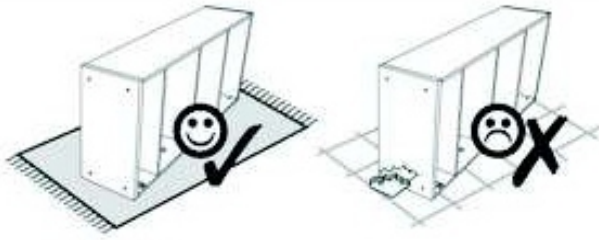

5

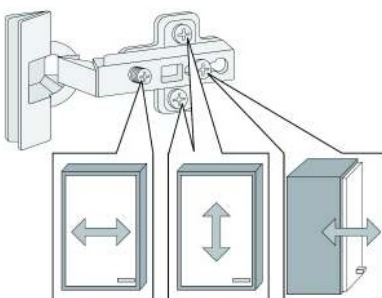
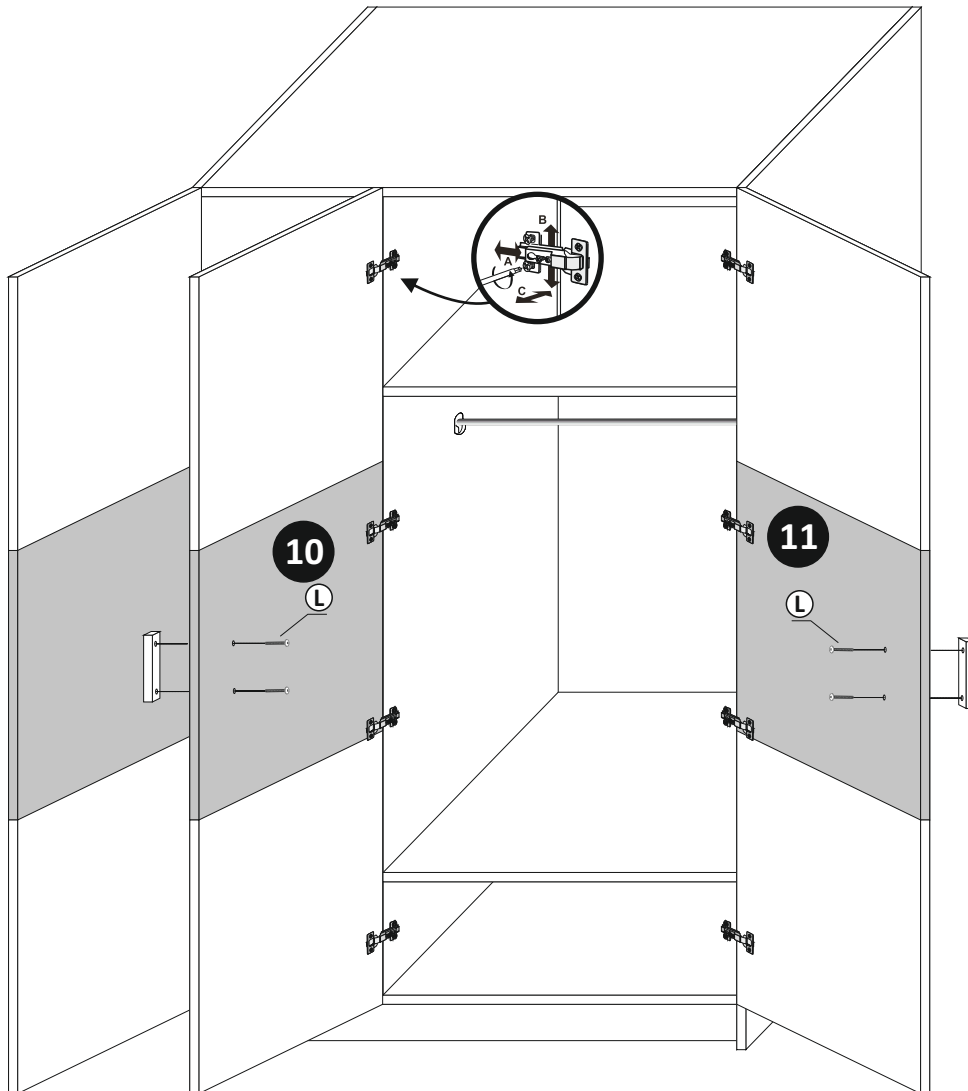

Türen einstellen (Scharniere justieren)
 Adjusting the doors (adjusting the hinges)
Deuren instellen (scharnieren afstellen)
 Nastawić drzwi (wyrównać zawiasy)
Капıларın аярланması (ментешелерін сеویه аярı)
 Регулировка дверей (регулировка шарнира)